



# Lifting Gear Hire

Lifting Equipment Rental Specialists

North American Rental Headquarters

T: 800.878.7305 | F: 708.430.3536 | www.RentLGH.com | Rentals@RentLGH.com

## Shackles | .33 - 150 Ton | Bolt Type

- Working Load Limit permanently shown on every shackle.
- Forged – Quenched and Tempered, with alloy pins.
- Capacities 1/3 thru 55 metric tons.
- Look for the Red Pin®...the mark of genuine Crosby quality.
- Shackles 55 metric tons and smaller can be furnished proof tested with certificates to designated standards, such as ABS, DNV, Lloyds, or other certification.
- Certification must be requested at time of order.
- Shackles 85 metric tons and larger can be provided as follows: Non Destructive Tested, Serialized Pin and Bow, Material Certification (Chemical), Certification must be requested at time of order.
- Hot Dip galvanized or Self Colored.
- Fatigue rated.

Specifications							
Nominal Shackle Size (in.)	Working Load Limit* (t)	Model				2130 Weight Each (lbs.)	2150 Weight Each (lbs.)
		G-2130 Galv.	S-2130 S.C.	G-2150 Galv.	S-2150 S.C.		
2	35	1019677	1019686	1019971	1019980	52.25	46.75
2 1/2	55	1019695	1019702	1019999	1020004	98.25	85.00
3	† 85**	1019711	—	1020013	—	154.00	124.25
3 1/2	† 120**	1019739	—	—	—	265.00	—
4	† 150**	1019757	—	—	—	338.00	—

Green shading reflects rental inventory.

G-2130 S-2130



G-2150 S-2150

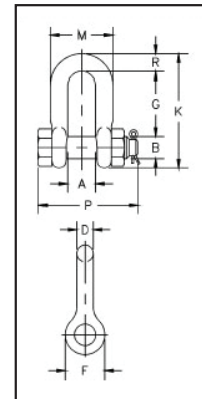
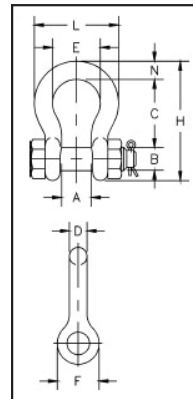

Dimensions																	
Nominal Shackle Size (in.)	Working Load Limit* t	Dimensions (in)														Tolerance +/-	
		A	B	C	D	E	F	G	H	K	L	M	N	P	R	C & G	A
2	35	3.25	2.25	7.75	2.00	5.75	4.81	6.75	13.68	12.28	9.97	7.25	2.40	10.41	2.00	.25	.13
2 1/2	55	4.13	2.75	10.50	2.62	7.25	5.69	8.00	17.84	14.84	12.87	9.38	3.13	13.56	2.62	.25	.25
3	† 85**	5.00	3.25	13.00	3.00	7.88	6.50	8.50	21.50	16.88	14.36	11.00	3.62	16.50	3.50	.25	.25
3 1/2	† 120**	5.25	3.75	14.63	3.62	9.00	8.00	—	24.63	—	16.50	—	4.12	19.00	—	.25	.25
4	† 150**	5.50	4.25	14.50	4.10	10.00	9.00	—	25.69	—	18.42	—	4.56	19.75	—	.25	.25

\*Note: Maximum Proof Load is 2.0 times the working load limit. Minimum ultimate strength is 6 times the working load limit.

\*\*Furnished in Anchor style only.

+ Individually Proof Tested with certification and furnished with round head bolts with welded handles.